

BONTRAGER.COM



RECYCLABLE PACKAGING

*BONTRAGER & BONTRAGER B-DOT ARE REGISTERED TRADEMARKS OF
TREK BICYCLE CORPORATION. ©2005 TREK BICYCLE CORPORATION,
WATERLOO, WISCONSIN 53594 USA. ALL RIGHTS RESERVED.*



BONTRAGER™

Big Earl™ Grips • Part Number 264734



© Copyright Trek Bicycle Corporation 2005
All rights reserved

BONTRAGER BIG EARL GRIPS

OWNER'S MANUAL

TABLE OF CONTENTS

<i>Introduction</i>	1-2
<i>Bontrager Big Earl grips</i>	3-6
<i>Inspecting grips</i>	4
<i>Adjusting grips</i>	5-6
<i>Installation instructions</i>	7-9
<i>Checking torque with Bontrager grip wrench</i>	10-11
<i>Limited Warranty</i>	12-13

INTRODUCTION

Bontrager wheelsets and components are built to exceed the demands of professionals. Pooling vast resources, Bontrager is able to deliver cutting-edge performance without sacrificing strength or durability.

Top level riders, including World Champions, compete on the same product that you can purchase.

Whether leading the pack into Paris or double-jumping in Vancouver, Bontrager has you covered.

Thanks for buying Bontrager.

Please read all of the supplied instructions thoroughly before using your Bontrager gear; the manual contains important safety and maintenance information. Also visit the Bontrager web site for important updates.

If you do not understand the information in this manual, or you have a question about your components or wheelset that this manual does not cover, consult your Bontrager dealer, or contact us.

Mailing address:

Bontrager Components & Wheelsets

Attn: Customer Service

801 W. Madison St.

Waterloo, Wisconsin 53594

Telephone:

In the United States, call 920.478.4678

Web or e-mail:

<http://www.bontrager.com>

BONTRAGER BIG EARL GRIPS

These grips (Figure 1) have a locking mechanism that prevents rotation or sliding, increasing control.

These high-performance grips offer these features:

- *Simple locking system stops rotation*
- *Carbon-compatible design: will not break fibers or in other ways damage a carbon handlebar*
- *Low weight: just 100 grams per pair*

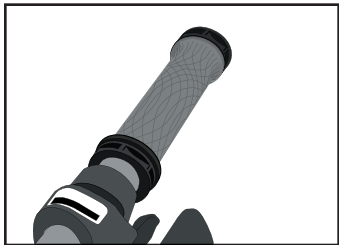

Figure 1: Bontrager Big Earl grips

Grips provide your primary hand position on a mountain-style handlebar. Their security is important to your safety.

 **WARNING**

Improperly adjusted or tightened grips can cause you to lose control and fall. Make sure the grips are positioned and tightened properly before riding the bike.

Inspecting grips

If you are unsure of the safety of your handlebar system, do not ride the bicycle; take the bicycle to your dealer for adjustments.

Once a month check your grips. Attempt to rotate them on the handlebars. If the grips slip or rotate, tighten the grip nuts with the Bontrager grip wrench (Figure 2). Tighten both grip nuts to 120-170 lb•in (13.6-19.3 Nm). See page 10 for instructions on using a torque wrench with the Bontrager grip wrench.

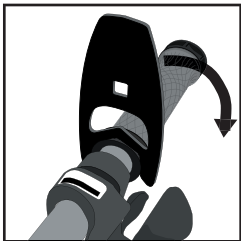

Figure 2: Tightening grip nut with Bontrager grip wrench

Adjusting grips

Grip position, the lateral placement of the grips on the handlebars, is largely a matter of personal preference blending comfort, efficiency, and balance. Your hands should comfortably rest on the grips as you shift, brake, or steer the bike.

To position the grips

1. *Loosen the handlebar grip nut(s) of the grips, and the clamp bolts of the controls, just enough*

that the grips and controls can be slid on the handlebar.

- 2. Position the grips and controls to the desired location.*
- 3. Tighten the controls according to their manufacturer's instructions, and tighten the grip nuts as shown in Inspecting grips.*

INSTALLATION INSTRUCTIONS

These instructions explain the steps to install new Bontrager grips. The correct installation of grips is critical to the rider's safety, so this work should be performed only by an experienced mechanic. If you are not sure of your ability to correctly install these grips, have them installed by your Bontrager dealer.

Check all parts for compatibility and condition before installing. The grips interface the handlebar. These parts must be compatible and the correct diameters for the grips to function correctly. If you are not sure if these grips are compatible with your bicycle, consult your dealer.

Make sure the handlebar is in good condition before installing grips. Look for any dents, bending, or other deformation, and replace a damaged handlebar. Clean the handlebar, if necessary, prior to installation.

TO INSTALL GRIPS

1. Remove the old grips.

To remove conventional grips, lubricate the inside surface of the grip with water or hair spray, and slide the grip from the bar.

2. If needed, slide the controls to make room for the Bontrager grips.

3. Slide the grips onto the handlebar.

4. Tighten the grip nuts with the Bontrager grip

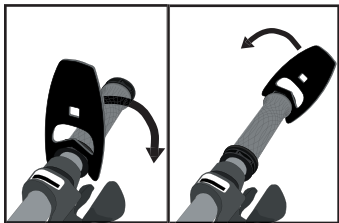

Figure 3: Tighten both grip nuts equally

wrench (Figure 3).

From either end of the grip, the threading is “normal,” so turn clockwise to tighten.

5. Install the handlebar plugs.

6. Follow the procedures in *Inspecting Grips*, page 4.

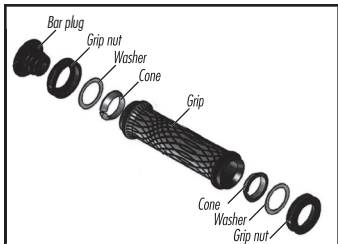

Figure 4: Bontrager Big Earl grip parts

CHECKING TORQUE WITH THE BONTRAGER GRIP WRENCH

- 1. Attach a standard 3/8" drive torque wrench to the matching square hole in the Bontrager grip wrench (Figure 5).*
- 2. Calculate the proper torque for this combination torque wrench/ grip wrench by multiplying the desired final torque by 0.85.*

The result of your calculation takes into account the additional length of the wrench added onto the torque wrench.

Example:

If the desired torque value is 170 in•lb, tighten the nut to a wrench reading of 200 in•lb ($200 \times 0.85 = 170$).

- 3. Tighten the grip nut as in Inspecting Grips, page 4.*

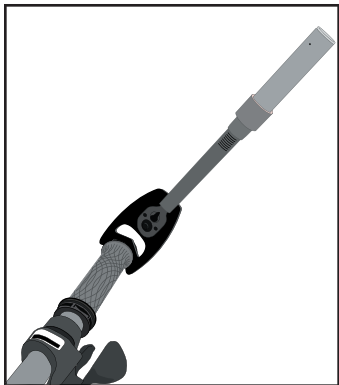

Figure 5: Torque wrench attached to Bontrager grip wrench

LIMITED WARRANTY

Bontrager warrants each new Bontrager component or wheelset against defects in workmanship and materials:

For the lifetime of the original owner-

- *Bontrager forks*

For one year-

- *All Bontrager parts*

This warranty does not cover-

- *Normal wear and tear*
- *Improper assembly*
- *Improper follow-up maintenance*
- *Installation of parts or accessories not originally intended for, or compatible with, the Bontrager components or wheelsets as sold*
- *Damage or failure due to accident, misuse, abuse, or neglect*
- *Labor charges for part replacement or changeover*

This warranty is void in its entirety by any modification of the wheelset, or components.

This warranty is expressly limited to the repair or replacement of a defective item and is the sole remedy of the warranty. This warranty extends from the date of purchase, applies only to the original owner, and is not transferable. Bontrager is not responsible for incidental or consequential damages. Some states do not allow the exclusion of incidental or consequential damages, so the above exclusion may not apply to you.

Claims under this warranty must be made through an authorized Bontrager dealer. Proof of purchase is required.

This warranty gives the consumer specific legal rights, and those rights may vary from place to place. This warranty does not affect the statutory rights of the consumer.