



Welcome.

www.bontrager.com

BT16_ION350R_RT

About this manual

This manual is for Bontrager lights Ion 350R and Ion 350RT.

The RT version allows wireless control when paired with the Bontrager Transmitter system.

Please read this entire manual. Check for updates at bontrager.com

IMPORTANT: Check your local lighting laws. Flashing Lights and full brightness may not be allowed in all locations. Ion 350 R/RT do not conform to the German road traffic regulation StVZO.

For more information

If you need help not offered by this manual, talk to your Bontrager retailer or visit bontrager.com

List of parts

Light (with battery enclosed)

"To see" LED light source provides a bright light up to 350 lumens in a focused 15-degree beam pattern to illuminate the road ahead.

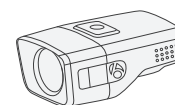

"To be seen" light sources at the sides of the light provide 270-degree visibility.

The permanently enclosed Lithium-ion (Li-ion) battery is a high-performance rechargeable 1450 mAh cell.

Quick connect mounting bracket (PN W527649)



Quick connect fits any size of round handlebar, 22.2mm to 35mm.

The mount may be turned 90 degrees for attaching to the stem.

Charger cable (PN W327765)

Micro USB cable can be plugged into a computer or wall adapter (adapter not included).



Accessories

This light is compatible with these optional mounting systems. Please see your Bontrager retailer for details.

Bontrager helmet mount (PN 428462)

- A strap mount that easily attaches a Bontrager Ion or Flare light to most helmets.

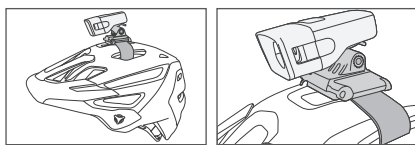

Bontrager Lithos helmet Blendr accessory mount (PN 516635)

- A Blendr mount that integrates into the Bontrager Lithos helmet.



Bontrager Ion handlebar mount (PN W530421)

- A hinged clamp that securely attaches an Ion light to the handlebar. Fits 22.2–31.8mm handlebars.

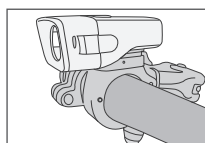

Bontrager Sync handlebar bracket (PN 418921)

- An adjustable rubber mount that fits 22.2–35mm handlebars or seatpost.

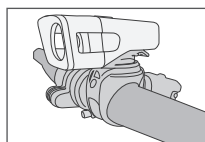

Bontrager Blendr accessories

- An attachment system designed as a feature of Bontrager Blendr stems that fits a variety of accessories. Please see your Bontrager retailer for details.

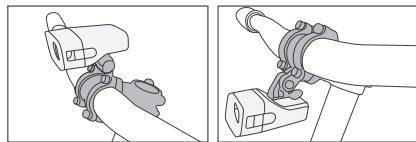

Installing the light

Before first use, charge the battery.

1. Place the Quick connect on the handlebar with the strap in front.



Front of bike

If desired, the bracket can be placed on the stem. Rotate the mount 90 degrees.

2. Stretch the strap under the bar and connect to the hook.

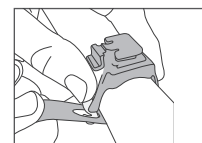

3. From the front, slide the light onto the bracket until the light engages.

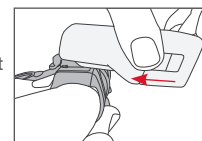

Removing the light

To remove the light, press down on the tab and slide the light forward.

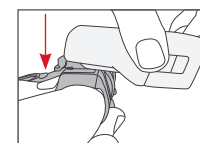

Operating the light

Power button

To turn on, press the power button.

When turned on, the Ion 350 will be in the output mode last used before turning off.

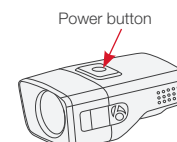

To turn off, press and hold the power button.

The power button LED tells the percent of battery charge that remains.

| Power button LED color | Run time |
|------------------------|--------------|
| Green | 25 to 100% |
| Red steady | 5 to 25% |
| Red flashing | Less than 5% |

To change mode

1. Quick-press the power button. Each press moves to the next mode (see table below).

Modes of the Ion 350

| Mode | Lumen Output (peak) | Runtime (hours) |
|-------------|--------------------------|-----------------|
| High | 350 | 1.5 |
| Medium | 200 | 3 |
| Low | 100 | 6 |
| Night Flash | 50 steady with 150 flash | 8 |
| Day Flash | 300 day pattern | 10 |

Low Battery Low Battery protection automatically adjusts the output brightness to 50 lumens when the battery supply goes below 5% and extends the light output for an additional 20 – 30 minutes.

High Beam* enables full brightness when paired with Transmitter Remote and center button on remote is pressed. Pressing the center button again will return light to previous mode.

* **Ion 350 RT only** - The high beam feature can be used only when paired to a Transmitter Remote.

Trail Configuration enables the Ion 350 R to toggle between 350 and 200 lumen steady modes. To enable and disable press and hold the power button for 10 seconds with the light off. The main LED will flash once indicating trail configuration has been enabled/disabled.

Charging the battery

Although the Ion 350R/RT is fully charged at the factory, it is recommended to charge it before first use. Complete charging takes approximately 4 hours from empty.

1. Plug the Micro charger cable into the USB port on the light.
2. Plug the cable into a computer or wall adapter.

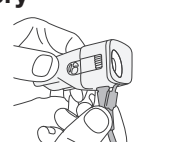

OR

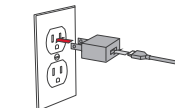

Status indicator while charging

While charging, the status indicator will flash:

- Red: Actively charging
- Green: Charging complete

NOTE: As the battery progresses from zero charge to full charge, the duration of the flashes will get progressively longer.

The power button LED indicates the battery charging status.

| Power button color | Battery power status |
|--------------------|---|
| Flashing red | Charging: flash rate slows as charge nears completion |
| Green | Charge complete |

For best results, charge at room temperature in a dry place. Avoid extreme conditions including wet, cold, or extremely hot.

Pairing to the Transmitter Remote (Ion 350RT only)

The Transmitter Remote, sold separately, allows remote control of the light. This feature is only available on the Ion 350RT.

For more complete instructions, refer to the Transmitter manual at bontrager.com. All pairings must be done in a single session. Before starting, place the remote and all lights within a small area.

NOTE: Move 15 feet from other Transmitter / ANT+ compatible lights to prevent accidental pairing. If a light is accidentally paired, start the pairing process over.

1. Place the light close to the Transmitter Remote (within 15cm / 6in).

2. Quick-press the power button on the light to turn it on, then quick-press to turn it off again. **NOTE:** After completing this step, do not press the power button on the light again until pairing is complete.
3. Press-and-hold the center button on the Transmitter Remote for at least 8 seconds. When the corner buttons flash, release the center button.
4. While the remote searches for a light, its center button flashes red. When the Transmitter Remote finds a light, the center button on the remote will change from red to green, and the found light will flash.
5. While the found light is still flashing, quick-press the button on the Transmitter Remote to which you would like to pair the light. The selected button will glow, and the found (paired) light will stop flashing and turn off. **NOTE:** After the pairing, the center button on the remote will flash red until the Transmitter Remote finds another available light.
6. Repeat Step 4 and Step 5 for each additional light to be paired. **NOTE:** After pairing is finished, pairing any additional lights will require that you repeat the entire pairing procedure.

CAUTION

The light may be hot to touch.

To exit pairing

1. When all lights are paired, quick-press the center button on the remote. The button will stop flashing and turn off.

To verify pairing

1. Quick-press the center button on the remote to turn on all paired lights.
2. Press-and-hold the center button to turn off all of them.
3. Turn on each light individually. Quick-press each paired button on the remote to turn on the individual light(s).
4. Press-and-hold the same button to turn off the light.

Using the Transmitter Remote

Controlling Lights with the Transmitter Remote

To turn on all lights

ON: Quick-press the center button.

OFF: Press and hold the center button.

To turn on an individual light

ON: Quick-press the corner button that controls the light.

OFF: Press and hold the same button.

Trek Bicycle Corporation contact information:

North America

Trek Bicycle Corporation
801 West Madison Street
Waterloo, WI 53594 USA
Tel: 800-313-8735

Europe

Bikeurope BV
Ceintuurbaan 2-20C
3847 LG Harderwijk
The Netherlands
Tel: +31 (0)33 45 09 060

Australia

Trek Bicycle Corp. Au.
8 Townsville Street
(Level One)
Fyshwick (ACT)
2609 AU
Tel: +61 (02) 61 732 400

To change modes of an individual light

Each quick-press of a button that controls a light will cycle through the modes.

Seeing Battery Power Status of the light on the Remote

When a corner button is pressed, the center button will show the battery status of the light

| Button light color | Power remaining |
|--------------------|--------------------|
| Green | More than 25% |
| Red | Between 5% and 25% |
| Blinking red | Less than 5% |

Travelling with the battery

Li-ion batteries cannot be shipped by air due to an overheating hazard. When traveling by air, place the light in your carry-on.

Statements of Regulatory Compliance

FCC Compliance

Ion 350RT

This device complies with part 15 of the FCC Rules. Operation is subject to the following conditions: (1) this device may not cause harmful interference, and (2) this device must accept any interference received, including interference that may cause undesired operation.

NOTE: This equipment has been tested and found to comply with the limits for a Class B digital device, pursuant to Part 15 of the FCC Rules. These limits are designed to provide reasonable protection against harmful interference in a residential installation. This equipment generates uses and can radiate radio frequency energy and, if not installed and used in accordance with the instructions, may cause harmful interference to radio communications. However, there is no guarantee that interference will not occur in a particular installation.

This product may cause interference to radio equipment and should not be installed near maritime safety communications equipment or other critical navigation or communication equipment operating between 0.45-30 MHz. If this equipment does cause harmful interference to radio or television reception, which can be determined by turning the equipment off and on, the user is encouraged to try to correct the interference by one or more of the following measures:

- Reorient or relocate the receiving antenna.
- Increase the separation between the equipment and receiver.
- Connect the equipment into an outlet on a circuit different from that to which the receiver is connected.
- Consult the dealer or experienced radio / TV technician for help.

NOTES: THE MANUFACTURER IS NOT RESPONSIBLE FOR ANY RADIO OR TV INTERFERENCE CAUSED BY UNAUTHORIZED MODIFICATIONS TO THIS EQUIPMENT. ANY CHANGES OR MODIFICATIONS NOT EXPRESSLY APPROVED BY THE MANUFACTURER OF THIS DEVICE COULD VOID THE USER'S AUTHORITY TO OPERATE THE DEVICE.

Caring for the battery

Store the battery at room temperature in a dry place. Avoid moisture, or extreme hot or cold. Store the battery in the charged condition. Avoid 'deep discharge.' Battery life will decrease if the battery is stored in a fully discharged condition.

Over time, the run time of the battery will diminish. Expect about 500 full charges, depending on care. After a full life, the battery will continue to charge but with a lower run time. When the run time is unsatisfactory, do not open the case of the light or incinerate; please recycle.

⚠ WARNING

A bicycle without correct lights and reflectors might be difficult for other people to see, and you might not be able to see. If you can not see, or other people can not see you, you could have an accident. Make sure your lights operate correctly and that batteries are charged.

Specifications

- Ion 350R and Ion 350RT: 3.7Vdc, 1450mAh, 5.5Wh
- Ion 350RT: Frequency-2.45GHz, Maximum Rf Power- 1mW

Industry Canada Compliance

Ion 350RT - CAN ICES-3(B)/NMB-3(B)

This device complies with Industry Canada license-exempt RSS standard(s).

Operation is subject to the following two conditions: (1) this device may not cause interference, and (2) this device must accept any interference, including interference that may cause undesired operation of the device.

Le présent appareil est conforme aux CNR d'Industrie Canada applicable aux appareils radio. Exempt de licence. L'exploitation est autorisée aux deux conditions suivantes: (1) l'appareil ne doit pas produire de brouillage, et (2) l'utilisateur de l'appareil doit accepter tout brouillage radioélectrique subi, même si le brouillage est susceptible d'en compromettre le fonctionnement.

This Ion 350R/RT lighting equipment complies with FCC and IC radiation exposure limits set forth for an uncontrolled environment. The radiated output power of the Ion 350RT Wireless Device is below the Industry Canada (IC) radio frequency exposure limits, when used as directed in this manual (Note: attaching this light to a helmet changes the absorption characteristics of the light-body system). This equipment is in direct contact with the body of the user under normal operating conditions. This transmitter must not be colocated or operating in conjunction with any other antenna or transmitter. Status of the listing in the Industry Canada's REL (Radio Equipment List) can be found at the following web address: <http://www.ic.gc.ca/app/sitt/reltel/srch/nwRdSrch.do?lang=eng>

Additional Canadian information on RF exposure also can be found at the following web address: <http://www.ic.gc.ca/eic/site/smt-gst.nsf/eng/sf08792.html>

Cet appareil est conforme aux limites d'exposition à la fréquence radio (FR) d'IC et de FCC. La puissance de sortie émise par l'appareil de sans fil Ion 350R et Ion 350RT est inférieure à la limite d'exposition aux fréquences radio d'Industrie Canada (IC). Cet appareil est en contact direct avec l'utilisateur dans des conditions normales d'utilisation. L'émetteur ne doit pas être co-implémenté ou utilisé conjointement avec une autre antenne ou un autre émetteur. Ce périphérique est homologué

Recycling

Please recycle the battery.

In the US, you can find out where to do this at call2recycle.org/

This symbol on the product(s) and / or accompanying documents means that used electrical and electronic products should not be mixed with general household waste. For proper treatment, recovery and recycling, outside the US, please take this product(s) to designated collection points. Alternatively, in some countries you may be able to return your products to your local retailer upon purchase of an equivalent new product. Disposing of this product correctly will help save valuable resources and prevent any potential negative effects on human health and the environment, which could otherwise arise from inappropriate waste handling. Please contact your local authority for further details of your nearest designated collection point. Penalties may be applicable for incorrect disposal of this waste, in accordance with your national legislation.

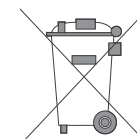

pour l'utilisation au Canada. Pour consulter l'entrée correspondant à l'appareil dans la liste d'équipement radio (REL - Radio Equipment List) d'Industrie Canada rendez-vous sur:

<http://www.ic.gc.ca/app/sitt/reltel/srch/nwRdSrch.do?lang=fra>

Pour des informations supplémentaires concernant l'exposition aux RF au Canada rendezvous sur: <http://www.ic.gc.ca/eic/site/smt-gst.nsf/eng/sf08792.html>

European Union Compliance

Ion 350R and Ion 350RT do not comply with German StVZO regulations!

Trek Bicycle Corporation and Bontrager hereby declare that the wireless device identified as 'Ion 350RT' and 'Ion 350R' are in compliance with the following European Directives:

- Radio Equipment Directive 2014/53/EU (Ion 350RT only)
- EMC Directive 2014/30/EU
- Low Voltage Directive 2014/35/EU
- RoHS Directive 2011/65/EU

The full text of the EU declaration of conformity is available from your dealer, or at the following internet address: <http://www.bontrager.com/support>